

Operation Manual

IP-1015HS NETWORK HORN SPEAKER



interM

Warning

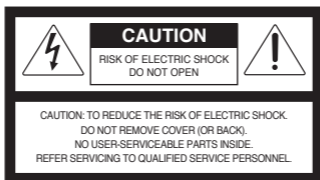

WARNING

To prevent fire or shock hazard, do not expose the unit to rain or moisture.



This symbol is intended to alert the user to the presence of uninsulated "dangerous voltage" within the product's enclosure that may be of sufficient magnitude to constitute a risk of electric shock to persons.



This symbol is intended to alert the user to the presence of important operation and maintenance (servicing) instructions in the literature accompanying the appliance.

Caution: These servicing instructions are for use by qualified service personnel only. To reduce the risk of electric shock, do not perform any servicing other than that contained in the operating instructions unless you are qualified to do so.

Attentions: Pour prévenir les chocs électriques ne pas utiliser cette fiche polarisée avec un prolongateur, une prise de courant ou une autre sortie de courant, sauf si les lames peuvent être insérées à fond sans en laisser aucune partie à découvert.

*Do not install this equipment in a confined space such as a book case or similar unit.

*The apparatus shall not be exposed to dripping or splashing and no objects filled with liquids, such as vases, shall be placed on the apparatus.

*Worded: "WARNING FOR YOUR PROTECTION PLEASE READ THE FOLLOWING-WATER AND MOISTURE: Unit should not be used near water (e.g. near a bathtub, washbowl, kitchen sink, laundry tub, in a wet basement, or near a swimming pool, etc). Care should be taken so that objects do not fall and liquids are not spilled into the enclosure through openings."

NOTE : This equipment has been tested and found to comply with the limits for a Class A digital device, pursuant to Part 15 of the FCC Rules. These limits are designed to provide reasonable protection against harmful interference when the equipment is operated in a commercial environment. This equipment generates, uses, and can radiate radio frequency energy and, if not installed and used in accordance with the instruction manual, may cause harmful interference to radio communications. Operation of this equipment in a residential area is likely to cause harmful interference in which case the user will be required to correct the interference at his own expense.

* It can be heated up if you use this product in closed box or ill-ventilated place.

Contents

Welcome	4
Unpacking	4
Installation	
Environment.....	5
Important Safety Instructions	5
Features	7
Contents and Accessories	7
Part Names and Function	8
Specification.....	11
Installation guide	12
Service	
Procedures	16
Schematic	16
Parts List.....	16
Warranty	16

Welcome

A personal welcome to you from the management and employees of Inter-M

All of the co-workers here at Inter-M are dedicated to providing excellent products with inherently good value, and we are delighted you have purchased one of our products.

We sincerely trust this product will provide years of satisfactory service, but if anything is not to your complete satisfaction, we will endeavor to make things right.

Welcome to Inter-M, and thank you for becoming part of our worldwide extended family!

Unpacking

Please take a few minutes to read this manual to familiarize yourself with important information regarding installation, product features, and operation.

As with most electronic devices, **ORIGINAL PACKAGING (OR EQUAL) IS REQUIRED** in the unlikely event that the product needs to be returned for servicing.

Installation

Environment

Never place this product in an environment which could alter its performance or reduce its service life. Such environments usually include high levels of heat, dust, moisture, and vibration.

Important Safety Instructions

1. Read these instructions.
2. Keep these instructions.
3. Heed all warnings.
4. Follow all instructions.
5. Do not use this apparatus near water.
6. Clean only with dry cloth.
7. Do not block any ventilation openings. Install in accordance with the manufacturer's instructions.
8. Do not install near any heat sources such as radiators, heat registers, stoves, or other apparatus (including amplifiers) that produce heat.
9. Do not defeat the safety purpose of the polarized or grounding-type plug. A polarized plug has two blades with one wider than the other. A grounding type plug has two blades and a third grounding prong. The wide blade or the third prong are provided for your safety. If the provided plug does not fit into your outlet, consult an electrician for replacement of the obsolete outlet.
10. Protect the power cord from being walked on or pinched particularly at plugs, convenience receptacles, and the point where they exit from the apparatus.
11. Only use attachments/accessories specified by the manufacturer.
12. Use only with the cart, stand, tripod, bracket, or table specified by the manufacturer, or sold with the apparatus. When a cart is used, use caution when moving the cart/ap-



paratus combination to avoid injury from tip-over.

13. Unplug this apparatus during lightning storms or when unused for long periods of time.
14. Refer all servicing to qualified service personnel. Servicing is required when the apparatus has been damaged in any way, such as power-supply cord or plug is damaged, liquid has been spilled or objects have fallen into the apparatus, the apparatus has been exposed to rain or moisture, does not operate normally, or has been dropped.

- AVOID EXCESSIVE HEAT, HUMIDITY, DUST AND VIBRATION

Keep the unit away from locations where it is likely to be exposed to high temperatures or humidity—such as near radiators, stoves, etc. Also avoid locations which are subject to excessive dust accumulation, or to vibration that could cause mechanical damage.

- AVOID PHYSICAL SHOCKS

Strong physical shocks to the unit may cause damage. Handle the unit with care.

- DO NOT OPEN THE CASE OR ATTEMPT REPAIRS OR MODIFICATIONS YOURSELF

This product contains no user-serviceable parts. Refer all maintenance to qualified Inter-M service personnel. Opening the case and/or tampering with internal circuitry voids the warranty.

- ALWAYS POWER OFF BEFORE MAKING CONNECTIONS

Always turn the AC mains OFF before connecting or disconnecting cables. This is important to prevent damage to the unit itself as well as other connected equipment.

- HANDLE CABLES CAREFULLY

Always plug and unplug cables (including the AC mains power cord) by gripping the connector, not the cord.

- CLEAN WITH A SOFT DRY CLOTH

Never use solvents such as benzine or paint thinner to clean the unit. Wipe clean with a soft, dry cloth.

Features

- ALL-IN-ONE SPEAKER SYSTEM
- POE+ (IEEE 802.3AT TYPE2 CLASS4) SUPPORTED
- POE+ 10W OUTPUT
- POE 3.7W OUTPUT
- PLAY WAV, MP3 FILES
- CONTACT INPUT/OUTPUT
- 10/100 BASE-T ETHERNET
(Initial IP : 192.168.1.99)
- VOIP, BGM, SCHEDULER, TTS FUNCTION
- 1 GB USER INTERNAL MEMORY
- DUSTPROOF AND WATERPROOF FUNCTION (IP66)

Contents and Accessories

1. IP-1015HS x 1EA
2. Operation Manual x 1EA
3. 3.5mm 4P Euro Block x 1EA

Part Names and Function

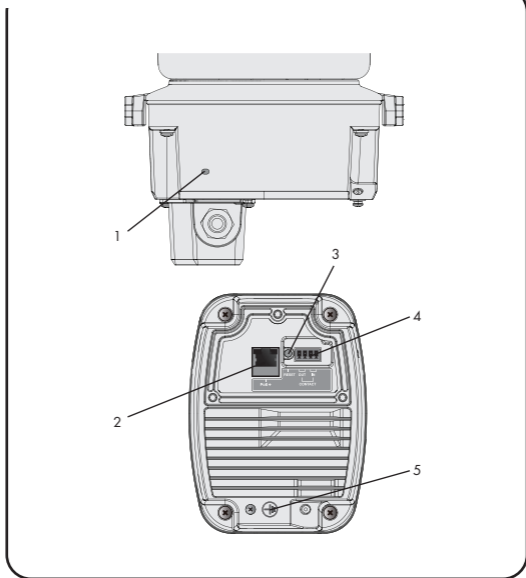

1. STATUS LED

During normal operation of the equipment, the green LED blinks at 0.5 second intervals.

2. ETHERNET CONNECTION TERMINAL (RJ-45, POE)

Connect with network equipment that supports PoE (Power over Ethernet).

IP address (default): 192.168.1.99

※The product will not turn on unless a PoE-enabled device is connected.

※ The specification of LAN cable is within 100m with 0.15Ω/m cable for PoE, and within 100m with 0.1Ω/m cable for PoE+. The total DC resistance value of the LAN cable is less than 15Ω in total for PoE and less than 10Ω for PoE+.

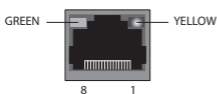

GREEN LED: Lights up when operating at 100Mbps.
 YELLOW LED: Turns ON when Ethernet is normally connected and blinks during data communication

PIN NO	DATA	POWER
1	TX+	+
2	TX-	+
3	RX+	-
4	NC	+
5	NC	+
6	RX-	-
7	NC	-
8	NC	-

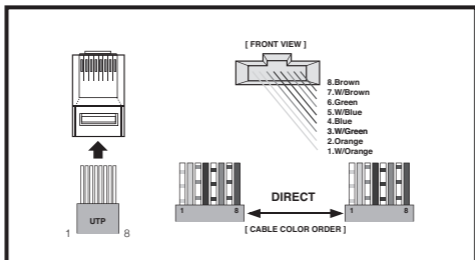

3. FACTORY RESET SWITCH

This is the factory reset switch for your equipment.

If you hold down the switch for more than 20 seconds, the STATUS LED blinks rapidly and initialization proceeds.

※ Keep the power on until normal operation (blinking at 0.5 second intervals). If the power is removed before initialization is complete, it may cause a malfunction.

4. CONTACT I/O TERMINAL

Contact input: Dry contact input terminal.

Contact output: Normally open dry contact output terminal.

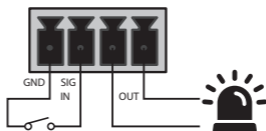

5. GROUND TERMINAL

This terminal is used for equipment grounding.

※ Ground connection should be as short as possible.

Specification

	IP-1015HS	
TYPE	Network Horn Speaker	
Driver	1" Dome type (10W), V/C: 28mm, 8Ω	
Maximum SPL [Cont]	121dB (PoE 802.3af)	124dB (PoE+ 802.3at)
Frequency Range	300Hz~5.5kHz	
Nominal Dispersion (HxV)	110° x 140°(1kHz) / 60° x 70°(4kHz)	
Enclosure	Material: ABS, Aluminium	
Amplifier		
Rated output power	10W	
Mic		
Embedded mic	50Hz ~ 16kHz	
Contact I/O		
Contact Input (1CH)	Dry Contact	
Contact Output (1CH)	Dry Contact (N.O : Normally Open), DC 30V, 1A Max	
Network		
Ethernet	10/100 BASE-TX PoE	
General		
Power	PoE (IEEE 802.3af, IEEE 802.3at)	
Connectors	Ethernet Jack (RJ-45)	
Operating temperature	-40°C ~ +60°C	
Ingress Protection Rating	IP66	
Power consumption	PoE (IEEE 802.3af) : 44~57 VDC, Max 12.95W PoE+ (IEEE 802.3at): 50~57 VDC, Max 25.5W	
Weight (Set)	2.4kg/5.3lb	
Dimensions (Set)	250(W) x 166(H) x 305(D)mm 9.8(W) x 6.5(H) x 12(D)in	

Installation guide

Installation

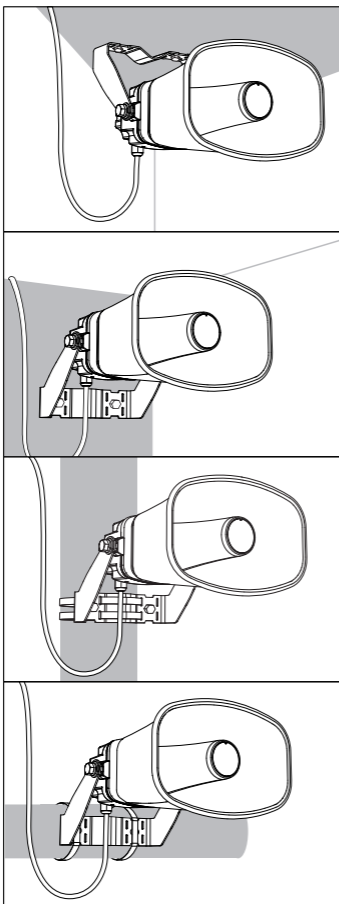

1-1

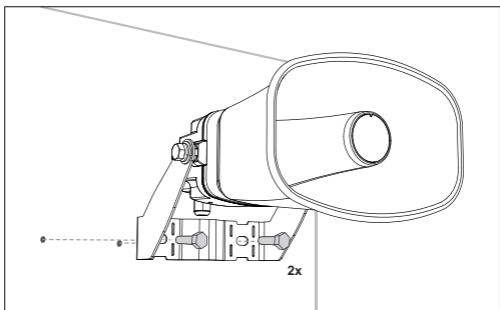
**CONCRETE SCREW STANDARD**

STANDARD	Drill bit diameter _M (mm)	Anchor length _L (mm)	Hexagon head _b (mm)	Insertion depth _h (mm)
50 mm	8 mm	50 mm	13 mm	45 mm

The product manufacturer is not responsible for any accident to damage occurring from using screws that do not meet the aforementioned standard specifications.

2-1

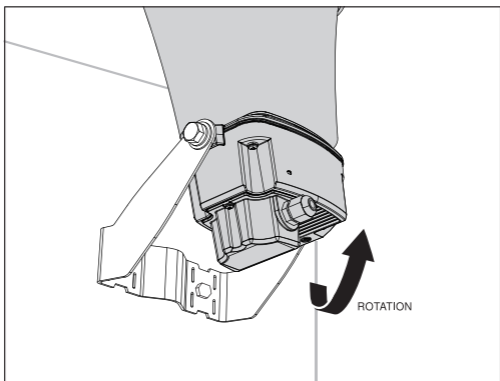

3-1

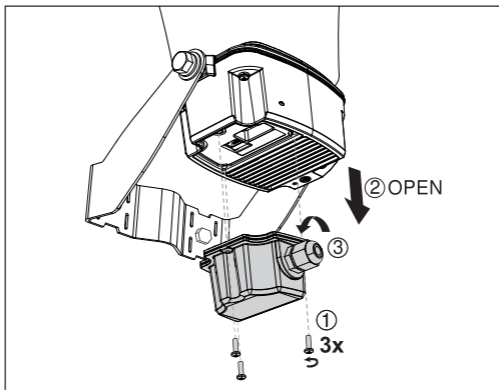

3-2

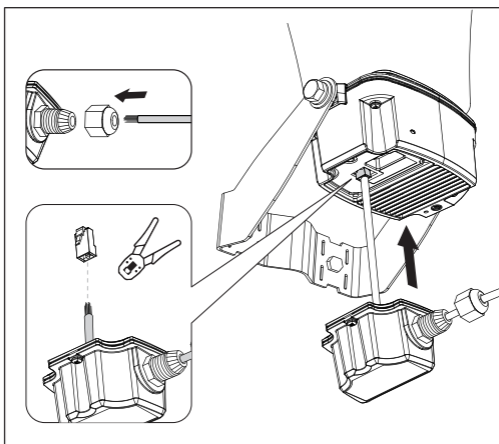

4-1

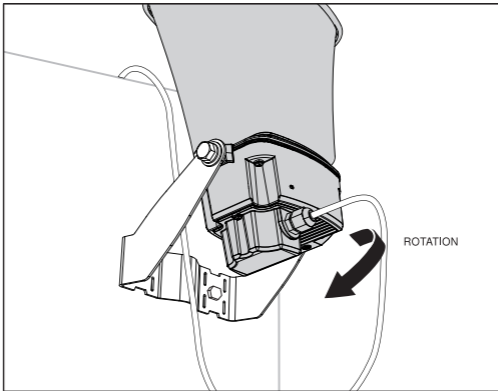

4-2

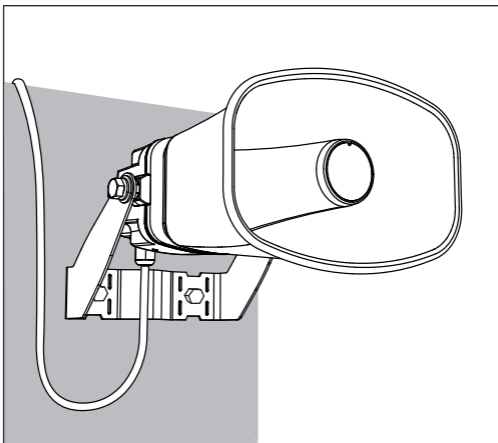

Service

Procedures

Ensure the problem is not related to operator error, or external system devices, Once it is certain that the problem is related to the product contact your warranty provider as described in the warranty section of this manual.

Schematic

A Schematic is available by contacting your warranty provider.

Parts List

A Parts List is available by contacting your warranty provider.

Warranty

Warranty terms and conditions vary by country and may not be the same for all products. Terms and conditions of warranty for a given product may be determined first by locating the appropriate country which the product was purchased in, then by locating the product type.

To obtain specific warranty information and available service locations contact Inter-M directly or the authorized Inter-M Distributor for your specific country or region.



RED OFFICE SUPPLIES LIMITED

📍 Eastern Commercial Complex, 73 Kakrail, 7th Floor,
Suite#12, Ramna, Dhaka-1000, Bangladesh

☎ 09614 61 61 61 ✉ info@redoffice.com.bd

🌐 www.redoffice.com.bd